

BTM PAPER TOWEL HOLDER

DESCRIPTION

Paper towel holder. 316 Stainless steel body. For integration behind the mirror as part of the SWA electronic wall mounted system. Easy installation. Space saving and functional solution that accommodates standard paper towels from your favorite brands (paper towels not included).

PRODUCT AT A GLANCE

PAPER	Material	316 Stainless Steel
	Dimensions	267 x 300mm x 105mm

ORDERING INFORMATION

MODEL	CODE	ADDITIONAL FEATURES
PAPER TOWEL HOLDER	03300148	Stainless Stainless paper towel holder

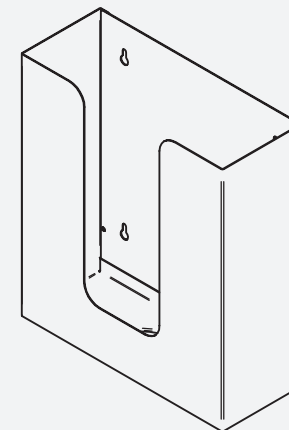
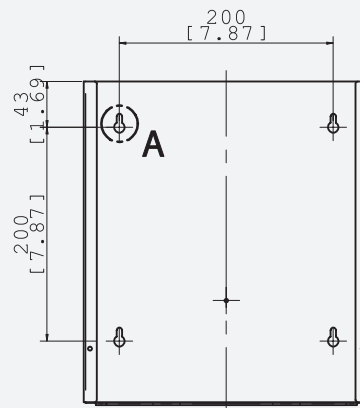
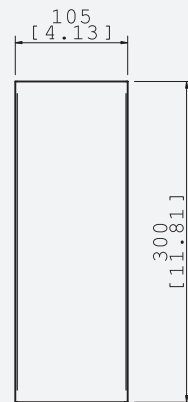
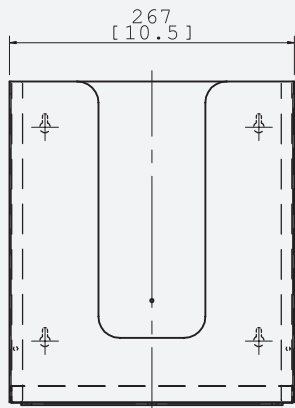

stern
STERN ENGINEERING LTD.

777 Passaic Avenue
Clifton NJ, 07012
USA: sternusa@sternfaucets.com
International: info@sternfaucets.com
Toll Free: 1-800-4364410

www.sternfaucets.com